

## INSULATION FOR HOT WATER TANK



### Polyester fibre fleece insulation for hot water tanks from 500 l

The outer shell is made of hard synthetic polystyrene sheeting, which is 1 mm thick with a grey (RAL 9022) textured surface. The inner insulation shell is made of polyester fibre fleece. The three-part shell is assembled using adjustable clip locking rails. Including lid and base insulation as well as EPS sealing plugs. Entire insulation: Fire resistance class B2, CFC-free and 100% recyclable.

#### Specifications

Property	Test method	Value	Unit
Density	-	12	kg/m
Fogging behaviour	DIN 75201 B	< 0.2	mg
Formaldehyde emission	VDA 275	< 2	mg/kg
Fire test	DIN 75200	< 100	mm/min
Fire resistance class	DIN 4102	B2	-
Fire resistance class in a compound	DIN 4102	B2	-
Continuous connection temperature	-	max. 130	°C
Colour	-	white	-
Thermal conductivity of the insulation	-	0.041	W/mK

## POLYESTER FIBRE FLEECE INSULATION FOR BE-SSP-2R – FROM 500 L

#### Dimensions

Type	ISOVL- BE-SSP-2R 750	ISOVL- BE-SSP-2R 1000
Item no.	1610709	1610710
Outer diameter	950 mm	1000 mm
Material thickness	100 mm	100 mm

## FLANGE PLATE FOR BE-SSP-2R – UP TO 500 L

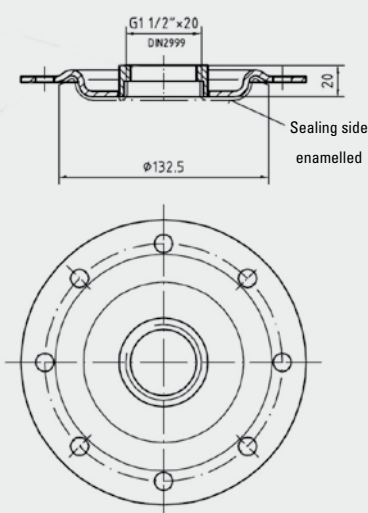

### Flange plate for an additional electric screw-in heating element for BE-SSP-2R tanks up to 500 l

Enamelled flange plate (DN 110) incl. seal with 6/4" sleeve for additional electric screw-in heating element; fits BE-SSP-2R 200, 300, 400 and 500.

#### Dimensions

Type	FLPE-SSP 64
Item no.	1610204
Material	S 235 JR steel
Plate thickness	10 mm
Enamelling	in compliance with DIN 4753